



MULTISPORT TRAINING COMPLEX

As part of the Rutgers Athletics Big Ten Build, the Multisport Training Complex is a state-of-the-art facility that aims to transform the student-athlete experience by enhancing and expanding academic spaces while improving individual development. Empower Rutgers' student-athletes by investing in this critical project and help lay the foundation for championship athletic programs at Rutgers. Leave a lasting impact on Rutgers Athletics by funding one of the following opportunities in your name or that of someone special with a gift payable over five years.

Name of Space	Naming Opportunity
Multisport Training Complex	\$10 million
SHARED SPACE	
High-Performance Café	\$2 million
Strength and Conditioning Area	\$2 million
Administrative Office Suite	FUNDED
Multisport Training Complex Lobby	FUNDED
Sports Medicine Suite	\$1 million
Team Film Room	\$500,000
Athletic Director's Office	\$500,000
Men's Staff Locker Room	\$250,000
Women's Staff Locker Room	\$250,000
MEN'S AND WOMEN'S BASKETBALL	
Basketball Practice Court #1	\$5 million
Basketball Practice Court #2	\$5 million
Men's Basketball Locker Room	TENTATIVE
Women's Basketball Locker Room	TENTATIVE
Men's Basketball Office Suite	FUNDED
Women's Basketball Office Suite	\$1 million
Men's Basketball Lounge	FUNDED
Women's Basketball Lounge	FUNDED
Men's Basketball Head Coach Office	FUNDED
Women's Basketball Head Coach Office	\$500,000
Men's Basketball Assistant Coach Office #1	FUNDED
Women's Basketball Assistant Coach Office #1	\$150,000
Men's Basketball Assistant Coach Office #2	TENTATIVE
Women's Basketball Assistant Coach Office #2	\$125,000
Men's Basketball Assistant Coach Office #3	TENTATIVE
Women's Basketball Assistant Coach Office #3	\$125,000
Men's Basketball Locker Room Individual Lockers*	\$2,500
Women's Basketball Locker Room Individual Lockers*	\$2,500

Name of Space	Naming Opportunity
WRESTLING	
Wrestling Practice Area	\$2.5 million
Wrestling Office Suite	\$750,000
Wrestling Locker Room	\$500,000
Wrestling Head Coach Office	\$500,000
Wrestling Lounge	TENTATIVE
Wrestling Assistant Coach Office #1	FUNDED
Wrestling Assistant Coach Office #2	\$125,000
Wrestling Assistant Coach Office #3	\$125,000
Wrestling Locker Room Individual Lockers*	\$2,500
GYMNASTICS	
Gymnastics Practice Area	\$2.5 million
Gymnastics Locker Room	\$500,000
Gymnastics Lounge	\$500,000
Gymnastics Sports Medicine Room	\$125,000
Gymnastics Head Coach Office	\$250,000
Gymnastics Assistant Coach Office #1	\$125,000
Gymnastics Assistant Coach Office #2	\$125,000
Gymnastics Locker Room Individual Lockers*	\$2,500
VOLLEYBALL	
Volleyball Locker Room	\$500,000
Volleyball Head Coach Office	\$250,000
Volleyball Assistant Coach Office #1	\$125,000
Volleyball Assistant Coach Office #2	\$125,000
Volleyball Locker Room Individual Lockers*	\$2,500
RUTGERS LEADERSHIP ACADEMY	
Rutgers Leadership Academy Suite	\$1 million
Rutgers Leadership Academy Director's Office	TENTATIVE
Rutgers Leadership Academy Support Staff Office	\$125,000

*Available exclusively to Rutgers letterwinners



1. FACILITY NAMING OPPORTUNITIES

- Naming opportunities shown are based on availability and are subject to change.
- All naming is subject to the approval of the University Naming Committee.
- Naming opportunities will exist only for the duration of the useful life of the Multisport Training Complex.
- Naming opportunity pledges are payable over no more than five years.
- To be eligible for naming, pledge must be paid in full by June 30, 2020.
- Donors can purchase multiple naming opportunities.

2. LOCKER NAMING OPPORTUNITIES

- Only Rutgers varsity letterwinners are eligible to name a locker.
- Locker naming pledge is \$2,500 per locker and is payable over no more than five years.
- To be eligible for locker naming, pledge must be paid in full by June 30, 2020.
- Locker number assignment will coincide with donor's jersey number while at Rutgers; there will be multiple names on each locker.



FIRST LEVEL

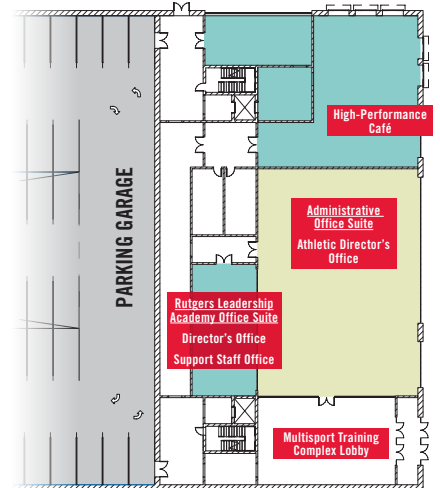

SECOND LEVEL

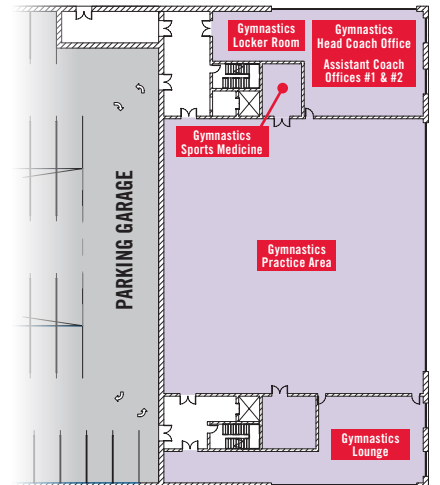

FOURTH LEVEL

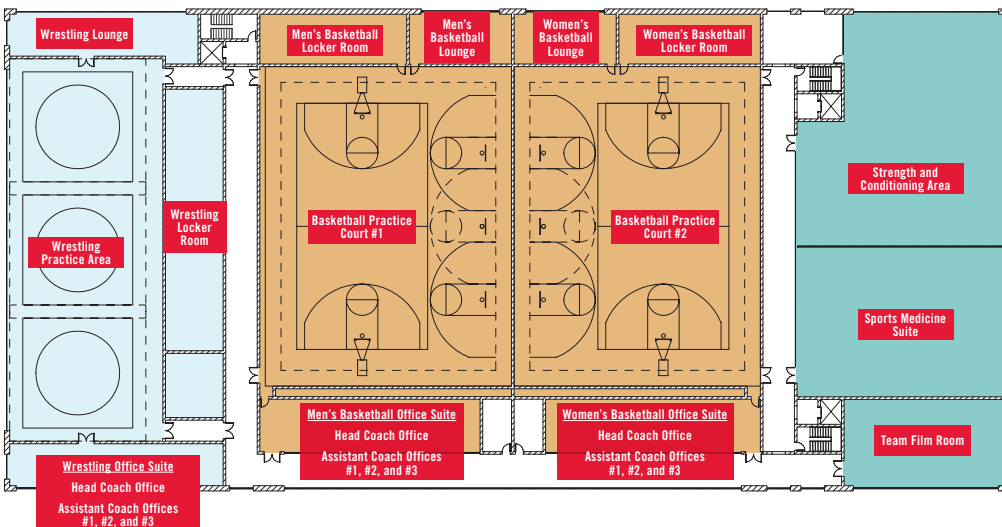

THIRD LEVEL

